

ORDINANCE NO. 6869

AN ORDINANCE relating to the annexation of an area known as Annexation Petition P-1 to King County Water District No. 90.

STATEMENT OF FACT:

1. A notice of intention proposing the annexation of an area known as Annexation Petition P-1 to King County Water District No. 90 was filed with the county council effective June 14, 1984.

2. King County Water District No. 90 has found the petition for annexation to be sufficient and has, by Resolution No. 413 concurred with the proposed annexation.

3. King County Water District No. 90 filed a Declaration of Non-significant Impact dated March 6, 1984, on the proposed annexation.

4. The county council held a public hearing on the 23rd day of July, 19 84 and has considered the criteria set forth in R.C.W. 57.02.040.

BE IT ORDAINED BY THE COUNCIL OF KING COUNTY:

SECTION 1. The annexation by King County Water District No. 90 of the area known as Annexation Petition P-1 and described in Section 4 herein is approved. This proposed annexation is consistent with R.C.W. 57.02.040 as described in the attached King County Council Annexation Report on Annexation Petition P-1.

SECTION 2. King County Water District No. 90 is the appropriate entity to serve the area proposed to be annexed.

SECTION 3. Completion of this annexation does not constitute county approval or disapproval of any other permits, certifications, or actions necessary to provide service to this annexation area.

1            SECTION 4. The area known as Annexation Petition P-1 to be  
2 annexed is described as follows:

3            Beginning at the East quarter corner of Section 12, Township  
4 23 North, Range 5 East, W.M., King County, Washington, said point  
5 being on the existing boundary of Water District No. 90;

6            Thence Westerly along the South line of the East half of the  
7 Northeast quarter of said Section 12 to the West line of said East  
8 half of the Northeast quarter of Section 12;

9            Thence Northerly along said West line to its intersection with  
10 the North right-of-way line of Primary State Highway No. 2, also  
11 known as the Renton-Issaquah Road;

12            Thence Easterly and continuing Northeasterly along said North  
13 right-of-way line to the East line of the East half of the  
14 Northeast quarter of said Section 12;

15            Thence Southerly along said East line to the East quarter  
16 corner of said Section 12 and the point of beginning.

17  
18            INTRODUCED AND READ for the first time this 2nd day  
19 of July, 19 84.

20            PASSED this 23rd day of July, 19 84.

21            KING COUNTY COUNCIL  
22            KING COUNTY, WASHINGTON

23            Gary Grant  
24            Chairman

25            ATTEST:

26  
27            Dorothy M. Owens  
28            Clerk of the Council

29            APPROVED this 30th day of July, 1984.

30  
31            Randy Powell  
32            King County Executive  
33

ORD NO 6869

DATE: July 20, 1984

Attachment  
Proposed Ord. No. 84-404 #7

KING COUNTY COUNCIL

ANNEXATION REPORT

King County Water District No. 90 Annexation of P-1

-----  
Files: BRB T.F. 6-1

I. BUILDING AND LAND DEVELOPMENT DIVISION REPORT:

BALD Recommendation: Approve

The proposed annexation is within the Newcastle Community Planning area. The proposed annexation is outside of the LSA and is not appropriate for sewer service. The annexation is consistent with the district's water plan.

BACKGROUND INFORMATION

Size of Parcel: 23.91 acres

Community Planning Area: Newcastle

Council District: 6

Existing Zoning and Land Use: Current zoning is SC-P. There are two single-family homes in the area. The Newcastle area zoning would permit single family residential use at one unit per acre, clustered.

II. COUNCIL STAFF RECOMMENDATION:

APPROVE FOR THE REASONS STATED IN THE BALD REPORT.

ORD NO 6869

# WATER DISTRICT NO. 90 PROPOSED ANNEXATION

P - 1

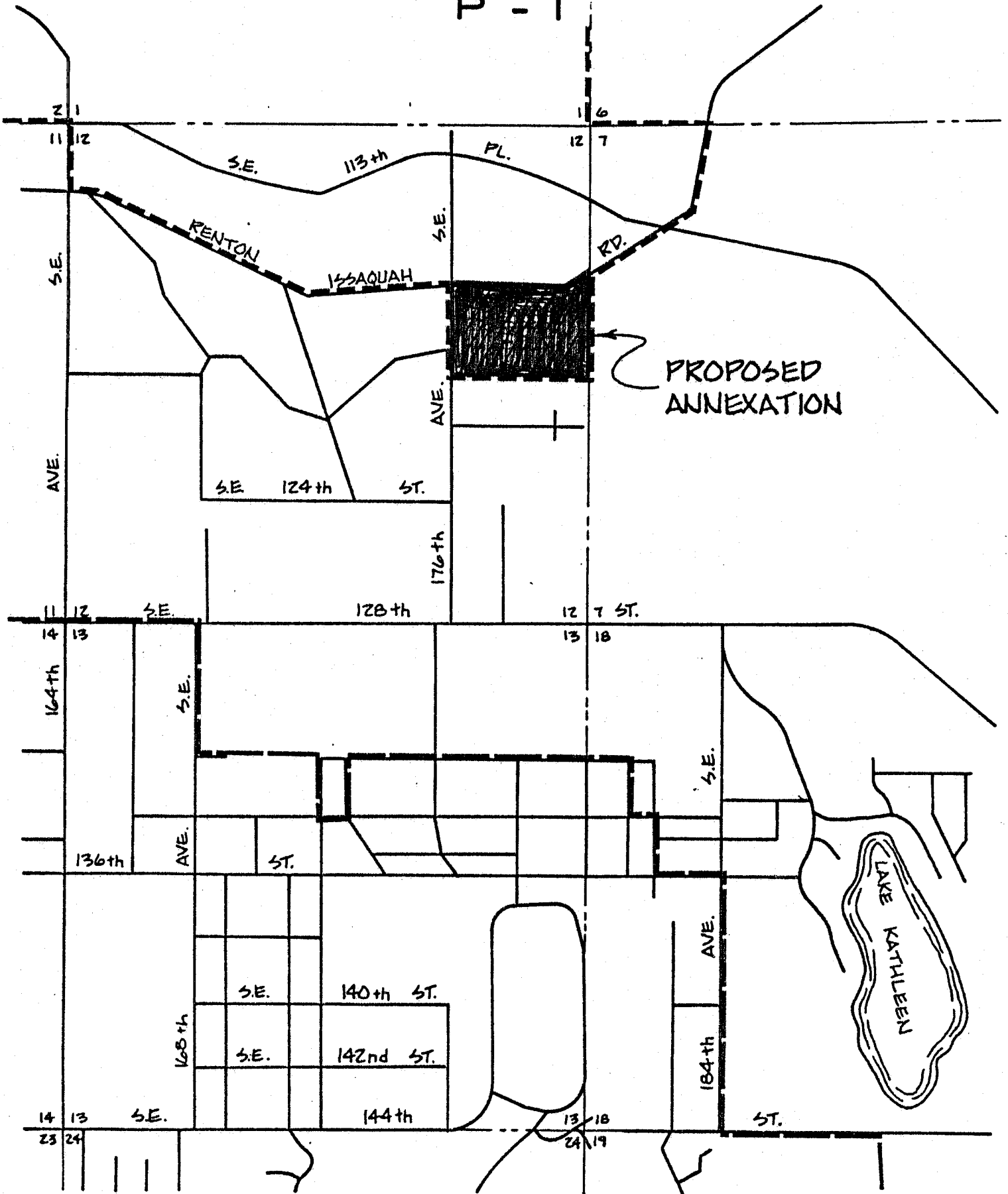

PROPOSED ANNEXATION

- W.D. NO. 90 BOUNDARY
- FIRE DIST. NO. 10 BOUNDARY